

YACHT

PRE-OWNED

SANLORENZO

SL

88/





02. Salon



03. Salon



04. Dining area



05. Owner's cabin



06. Owner's cabin



07. Owner's bathroom



08. Guest cabin



09. Guest bathroom



10. Wheelhouse



11. Galley



12. Cockpit



13. Flying bridge

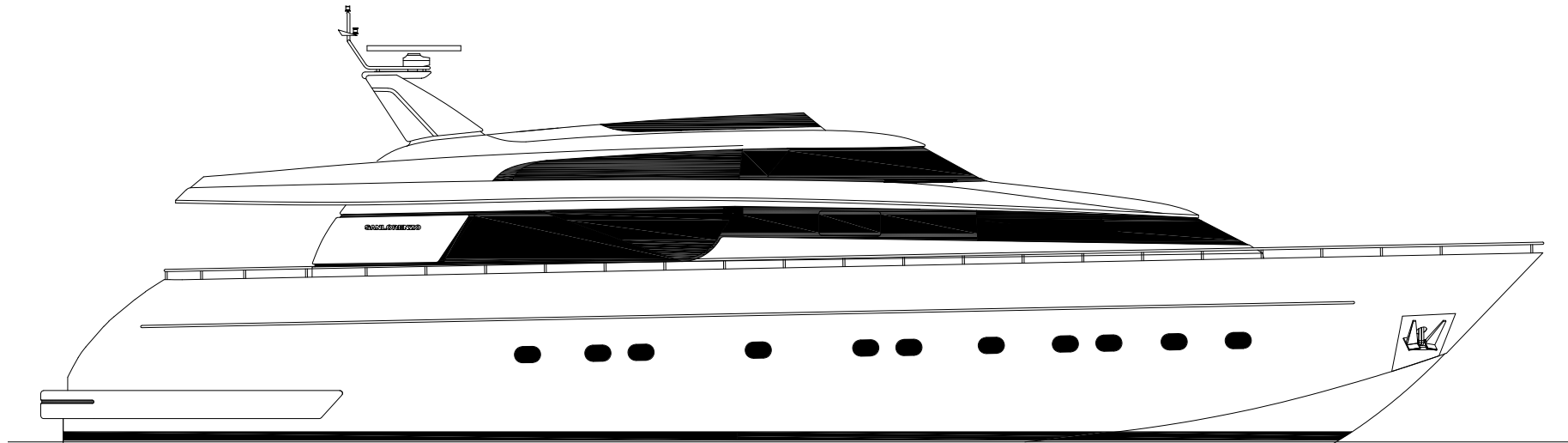

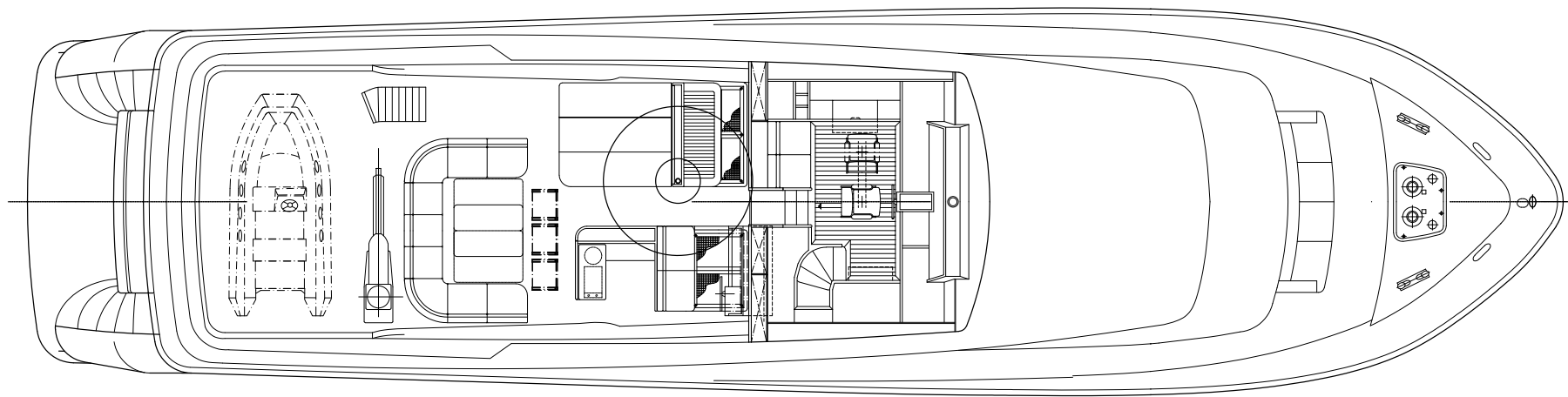

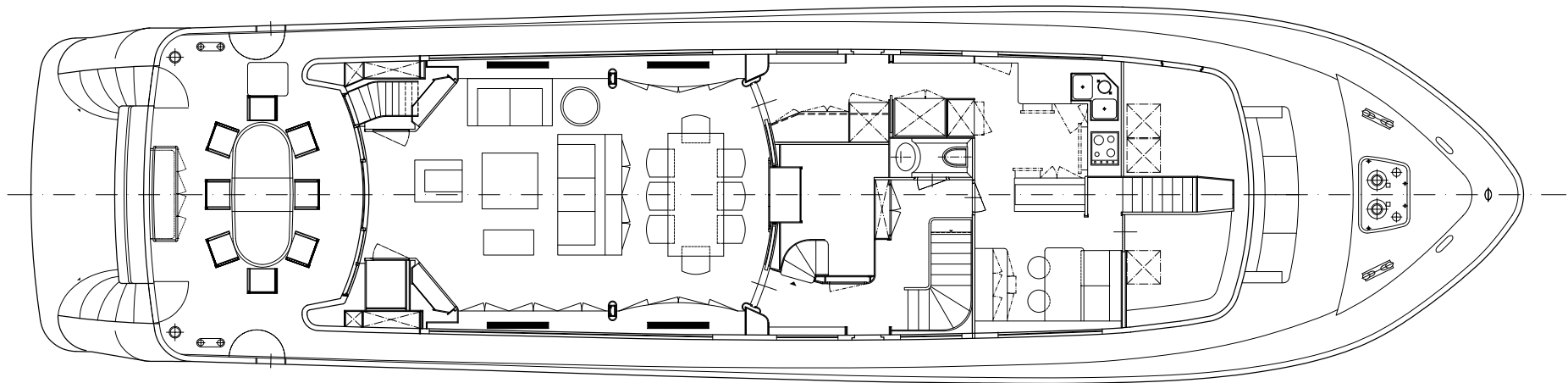

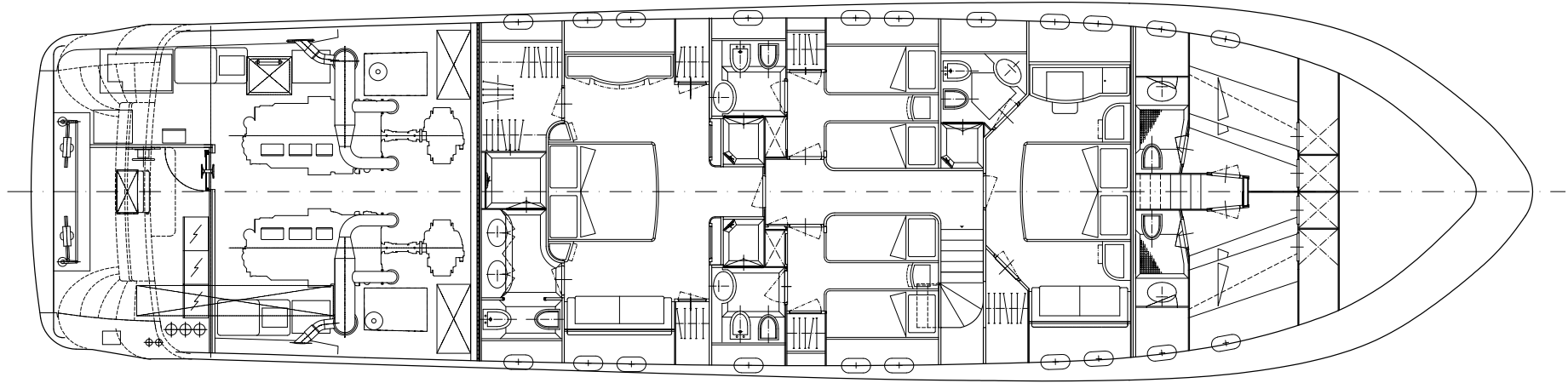

Cantiere: Sanlorenzo S.p.A.

Modello: SL 88

Anno: 2003

Lunghezza fuori tutto: 26,75 m

Larghezza: 6,75 m

Visibile: Viareggio

Bandiera: Inglese

Materiale scafo: VTR

Materiale ponte coperta: Teack

Motori: 2x I6V2000 M9I - 2x 2000 HP

Capacità cassa carburante: 10400 l

Capacità cassa acqua: 2000 l

Ore moto al 24-07-2018: 2080 h

Generatori: 2 x 27 kW Kohler

Ore generatori al 10-06-2018: SN 2100 h - DN 5400 h

Prezzo: € 1.700.000 IVA non pagata

Builder: Sanlorenzo S.p.A.

Model: SL 88

Year build: 2003

LOA: 26,75 m

Beam: 6,75 m

Lying: Viareggio

Flag: English

Hull material: GRP

Deck floor: Teack

Engines: 2x I6V2000 M9I - 2x 2000 HP

Fuel tank capacity: 10400 l

Water tank capacity: 2000 l

Engine Hours at 01-09-2017: 2080 h

Generators: 2 x 27 kW Kohler

Generators Hours at 01-09-2017: Prt 2100 h - Stb 5400 h

Price: € 1.700.000 VAT not paid

OPTIONS LIST

SL88/ 433

INTERNI

Cabina armatore con letto king size e bagno privato

Cabina VIP con bagno privato

Due cabine ospiti gemelle con bagni privati

Alloggio per quattro membri dell'equipaggio con servizi privati. Tende, tappeti, divani interni rinnovati (2013)

ELETTRONICI

Radar Furuno, Log-tachimetro, banderuola - Anemometro, Ripetitore (i), TV, Centro di navigazione, VCR, Plotter, Pilota automatico, Radio, Bussola, Lettore CD, GPS plotter, VHF DSC, Telefono satellitare, Sistema Nobertech (2014), faro di ricerca

AUDIO VIDEO

TV / VCR nel salone principale e in tutte le cabine,

Impianto audio CD nel salone principale di poppa esterno e in tutte le cabine. 3D TV (2015), HD TV (2, 2015)

Lettore DVD (2015)

Sistema Blu-ray 3D Europa / USA (2015)

INTERIOR

Master stateroom with king size bed and en-suite bathroom

VIP stateroom with en-suite bathroom

Two twin guest cabins with en-suite bathrooms

Accommodation for four crew with private facilities. Curtains, carpets, interior sofas renewed (2013)

ELECTRONICS

Furuno Radar, Log-speedometer, Wind vane – Anemometer, Repeater (s), TV, Navigation center, VCR, Plotter, Autopilot, Radio, Compass, CD player, GPS plotter, VHF DSC, Satellite phone, Nobertech system (2014), Searchlight

AUDIO VIDEO

TV/VCR in main salon and all cabins,

Audio system CD in main saloon aft outdoor and all cabins. 3D TV (2015),HD TV (2, 2015)

DVD player (2015)

Blu-ray 3D Europe/USA system (2015)

OPTIONS LIST

SL88/ 433

IMPIANTI

Elica di prua, Dissalatore 160 l / h

Aria condizionata 180.000 btu / h, 3 compressori indipendenti (2016)

Generatore Kohler 27kW,

Generatore Kohler 28kW extra silenzioso (2016),

Atlas ultra converter,

2 caricabatterie (2015),

Sistema di aspirazione di sentina tramite motori principali (come sistema di pompa di sentina di riserva)

ELETTRODOMESTICI

lavastoviglie Miele, lavatrice, microonde AEG, frigorifero, congelatore, frigorifero

Liebherr, piano cottura in vetroceramica, forno, grill (2014) sul fly

ATTREZZATURE

Convertitore di frequenza, Bimini Top (2014), ancore 2x130 kg con 100 metri di

catena ciascuno, Tutti i cuscini del flybridge e lettino prendisole e prendisole di prua

in Sunbrella (2015)

SYSTEMS

Bowthruster

Watermaker 160 l/h

Air conditioning 180.000 btu/h, 3 independent compressors (2016)

Kohler 27kW generator

Extra silent Kohler 28kW generator (2016)

Atlas ultra converter

2 x Battery chargers (2015)

Bilge suction system via main engines (as bilge pump system back up)

HOUSEHOLD APPLIANCES

Miele dishwasher, Washing machine, AEG Microwave, Refrigerator, Freezer, Liebherr fridge, Vitro-ceramic cooking top, oven, grill (2014) on flybridge

EQUIPMENTS

Frequency Converter, Bimini Top (2014), 2x130kg anchors with 100 metres of chain

each, All flybridge cushions & sunbed and forward sunbed in Sunbrella (2015)