

YACHT

PRE-OWNED

**SANLORENZO**

SD  
112/





Upper deck



Sun deck



Cockpit



Upper deck salon



Wheelhouse





Salon



Salon



Galley



Owner's cabin



Owner's bathroom



VIP cabin



Guest cabin





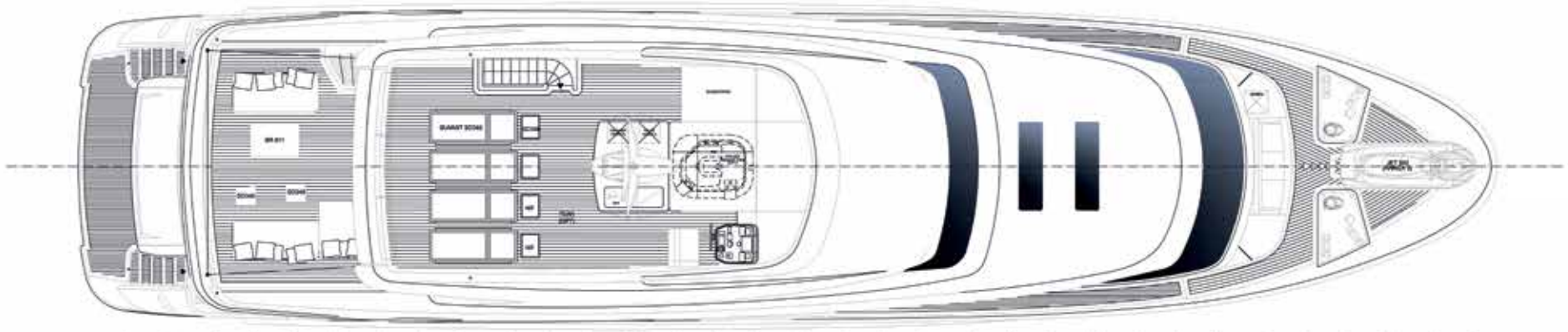

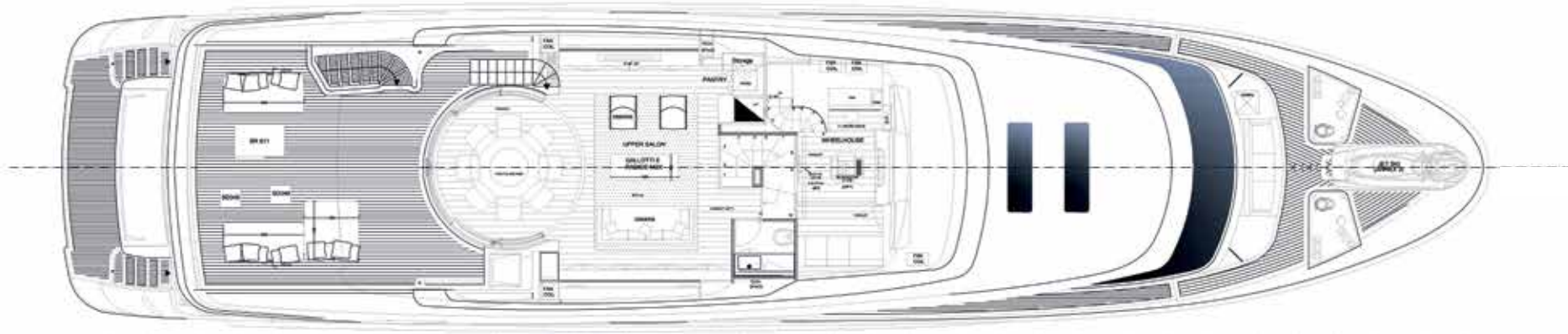

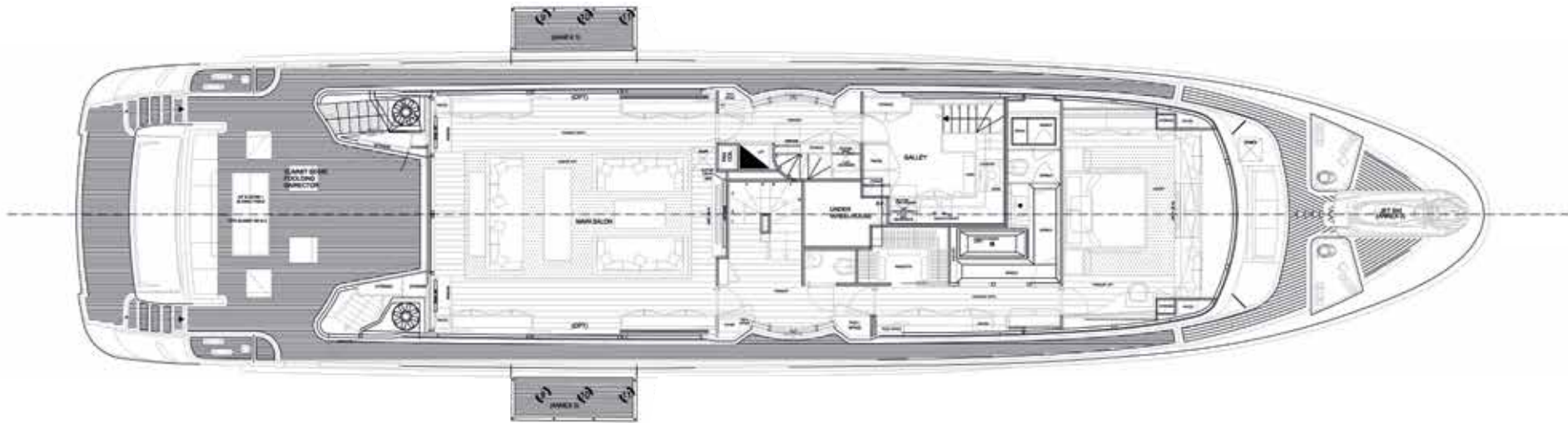

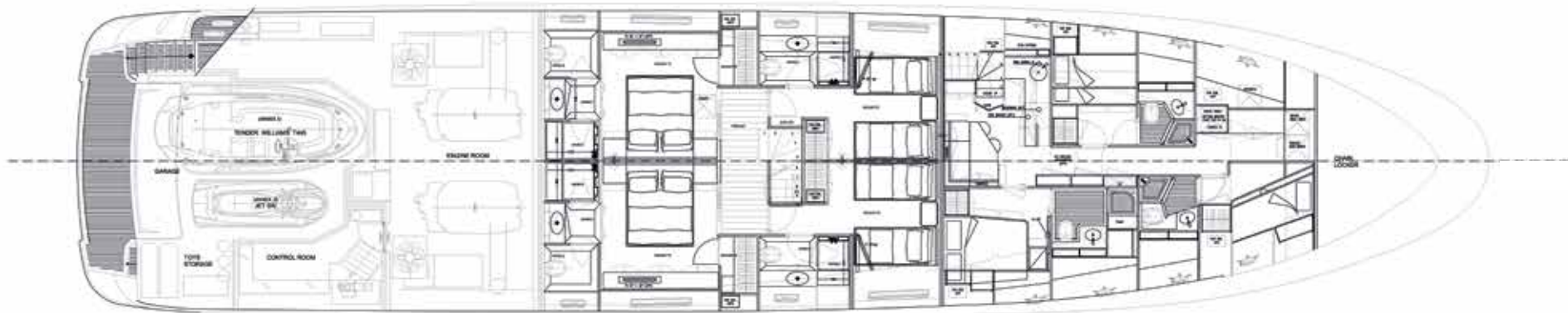

---

**Builder:** Sanlorenzo S.p.A.

---

**Model:** SD 112 - 35

---

**Year build:** 2014

---

**LOA:** mt. 33,60

---

**Beam:** mt. 7,66

---

**Lying:** La Spezia, Italia

---

**Flag:** Extra UE

---

**Hull material:** VTR

---

**Deck floor:** Teak

---

**Engines:** 2 x MTU 12V2000M72 - 2 x 1080 kW (1450 HP)

---

**Transmission:** shaft line

---

**Fuel tank capacity:** 25000 lt

---

**Water tank capacity:** 4000 lt

---

**Engine Hours at 01/02/2019:** 850h

---

**Generators:** Kohler 2 x 50 kw

---

**Generators Hours at 01/02/2019:** 1860h

---

**Price:** €. 7.900.000 + VAT

---

OPTIONS LIST

---

**SD112/ 35**

---

**INTERIORS**

---

Satin Elm wood and leather interiors. Main deck: saloon with 2 lateral doors, terraces and furniture

---

STBD hallway with door on side walkway, stairs to upper and lower deck, day toilet, master cabin in Bow area with furniture

---

Vanity, 2 sofas, dressing and bathroom, with bath and shower, PBD hallway on side walkway, stairs to wheelhouse and dumb

---

Waiter, kitchen with stairs to crew area. Upper deck: pilothouse with desk and sofa, saloon with furniture and dining table

---

Lavatory area with sink and dumb-waiter, bathroom. Sun deck: Jacuzzi, second control station and sunbathing area

---

Lower deck: 2 VIP cabins with bathroom, 2 guests cabins with double beds and bathroom

---

Crew area: dinette with furniture, Captain's cabin with bathroom, 2 cabins with bunk beds with bathroom, laundry

---

**ELECTRONICS**

---

Wheelhouse: 3 multifunction 19" monitor (GPS-ECO-Radar), autopilot AP 70, autopilot QS 80 joystick, control keyboard OP40

---

N2 tridata, gyro compass AR 78, sailor 6222DSC VHF, furuno Navtex NX-700

---

Sun Deck: multifunction 17" monitor, autopilot AP70, simrad autopilot QS 80 joystick, keyboard OP40, tridata

---

VHF RS82, radar 72mg, all electronics are Simrad

---

**ENTERTAINMENT**

---

TV with Hi-Fi system controlled by I pad in Saloon, TV with hi-fi system in upper deck saloon, TV with Hi-Fi in Owner's cabin

---

TV in VIP cabin with Hi-Fi, TV in guests cabins with Hi-Fi, TV in dinette area

---

Sat TV antenna KWHM9

---

**SYSTEMS**

---

Electric bow thruster (380 Volt), Electric fins stabilize, air conditioning (240.000 BTU), water maker (Idromar 230 L/H)

---

Hamman system, Alfa Laval, CCTV system, MTU cable control station connection, inverter, charge battery, glendening

---

OPTIONS LIST

---

**SD112/ 35**

---

**HOUSEHOLD - APPLIANCES**

---

Kitchen: electric cooking top, oven, stem oven, microwaves, refrigerators, freezers, dish washer, insinkerator

---

SWine cooler and Ice maker in PDB hallwa, refrigerator and Ice maker in Sun Deck. Crew area: refrigerator

---

N3 freezers, n2 washing machines, n2 dryers

---

**DECK EQUIPMENT**

---

Two winches with capstan, crane for rescue boat, two cockpit capstan

---

hydraulic gangway, garage for tender and Jet Sky

---

---

**MAIN OPTIONS INSTALLED ON BOARD**

---

Black and Grey water treatment system - HAMANN

---

Fuel separator - ALFALAVAL

---

JET-SKI HAULING AND LAUNCHING SYATEM IN GARAGE

---

PORTABLE CONTROL STATION MTU (CABLE I POINT OF CONTACT)

---

ADDITIONAL ELETRIC SKYLIGHT WITH ELETRIC CURTAIN IN OWNER CABIN

---

N2 SIDE BALCONY WITH LATERAL DOOR

---

TENDER - WILLIAMS T445

---

GYRO COMPASS - SIMRAD

---

MCA (LY2) SHORT RANGE COMPLIANCE

---

---

**LUXURY FURNITURE, LINEN AND MASTERPIECES**

---

There are on board some luxury furniture, linen and masterpieces which are in temporary use from our suppliers and they are not part of the equipment. These extra elements could be sold separately and they should be paid to Sanlorenzo S.p.A.

---

The lists are available upon request.

---